



A-DEC INC.
2601 CRESTVIEW DRIVE
POST OFFICE BOX 111
NEWBERG, OREGON 97132 USA
TELEPHONE (503)-538-9471

A-DEC DENTAL U.K., LTD.
AUSTIN HOUSE
11 LIBERTY WAY
ATTLEBOROUGH FIELDS INDUSTRIAL ESTATE
NUNEATON, WARWICKSHIRE
ENGLAND CV116RZ
PHONE: 0800-ADECUK (233285) WITHIN UK 00
44 24 7635 0901 OUTSIDE UK

A-DEC AUSTRALIA
41-43 BOWDEN STREET
ALEXANDRIA, N.S.W. 2015
AUSTRALIA
TELEPHONE (61) 1.800.225010

CHECK WITH LOCAL CODE AUTHORITIES ABOUT INSTALLATION REQUIREMENTS FOR THIS PRODUCT

INSTALLATION INSTRUCTIONS

A-DEC 4631 DUO DELIVERY SYSTEM OR 4635 ASSISTANT'S INSTRUMENTATION TO PREFERENCE COLLECTION™ TREATMENT CONSOLE

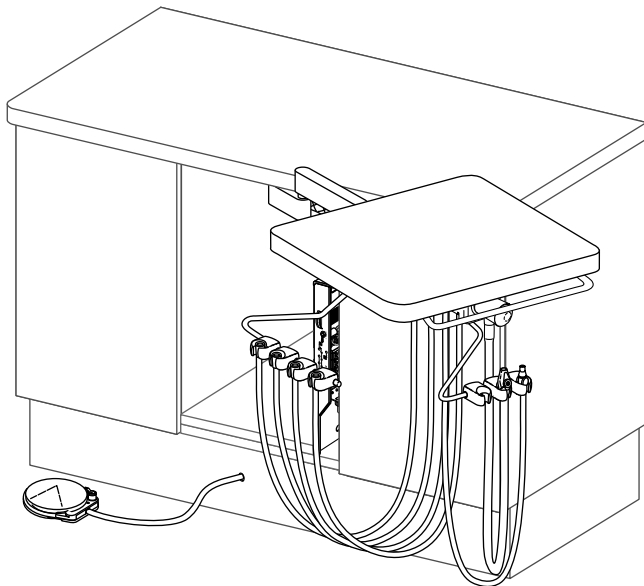

4631 DUO DELIVERY SYSTEM

YOU WILL NEED

- Adjustable wrench
- Phillips screwdriver
- Hex key set

INSTALL THE DELIVERY SYSTEM ASSEMBLY OR ASSISTANT'S INSTRUMENTATION TO THE WORK SURFACE

1. Remove the two button-head screws and washers from the underside of the work surface.

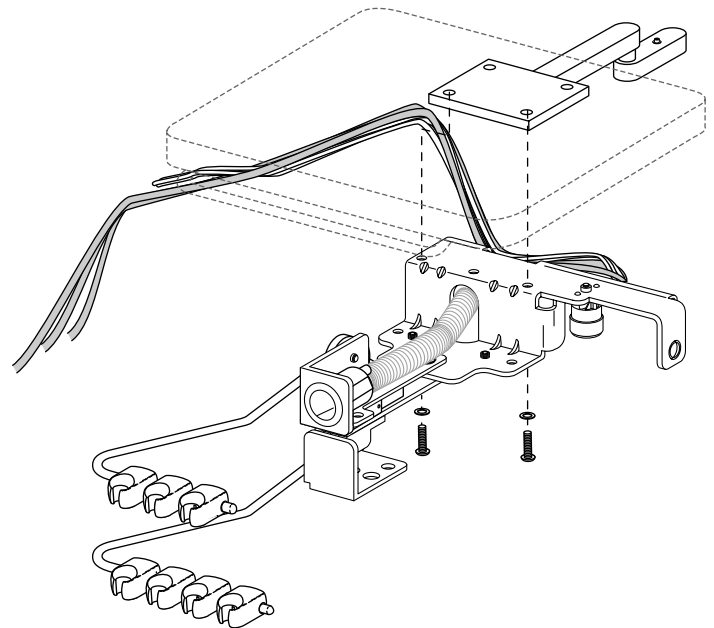

FIGURE 1

2. Using the two screws and washers, install the delivery system assembly to the work surface (see *Figure 1*).

NOTE

If installing only the 4635 Assistant's Instrumentation, go to **ROUTE THE UMBILICAL** (page 3).

3. Remove the cabinet doors.

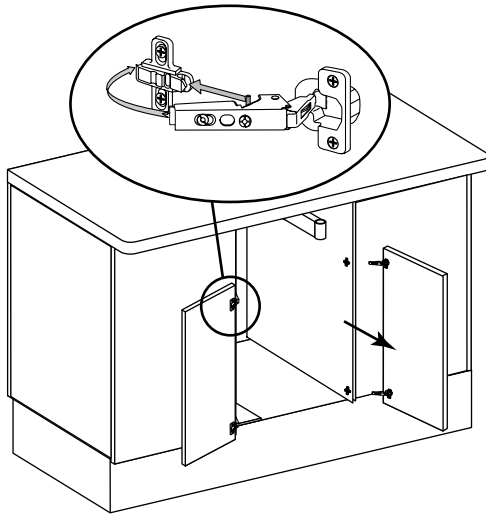

FIGURE 2

4. Remove the false bottom from the cabinet.
5. Slide the control head partially into the cabinet. Route the umbilical and tubing through the notch in the control head housing, through the cable clip attached to the housing and to the utilities in the cabinet base.

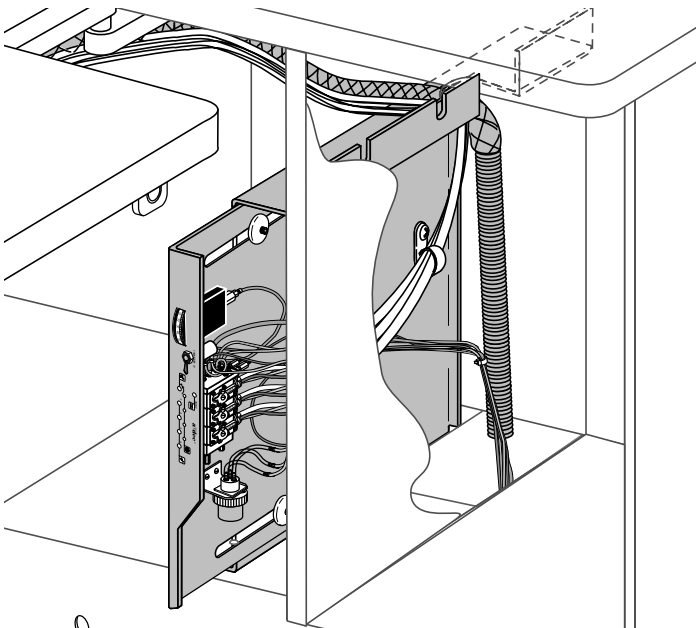

FIGURE 3

6. Align the control head housing to the threaded insert holes in the cabinet.

NOTE

Early revisions of 5580 cabinets require #10 x 5/8" wood screws which are no longer provided in this application.

7. Using four 10-32 x 1/2" long Phillips head screws from the kit, secure the control head to the cabinet.

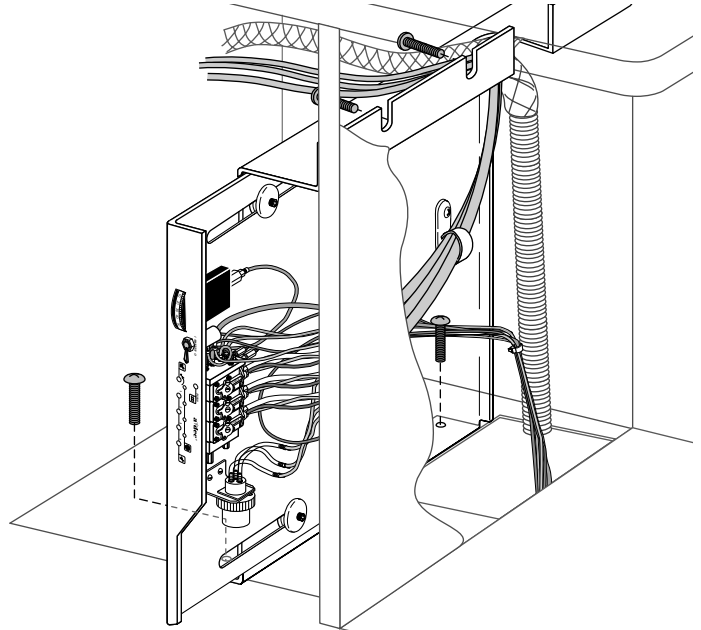
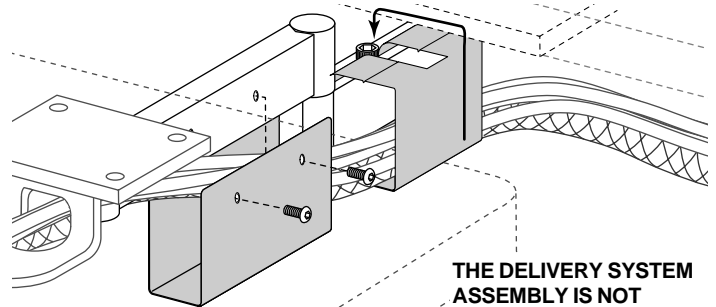

FIGURE 4

8. Slide the umbilical through the umbilical cover, then install the cover to the work surface arm using two button-head screws from the kit. Secure the umbilical by clipping the second umbilical cover over the work surface arm.



THE DELIVERY SYSTEM ASSEMBLY IS NOT SHOWN FOR CLARITY

FIGURE 5

9. Insert the foot control tubing through the front of the sub-base.

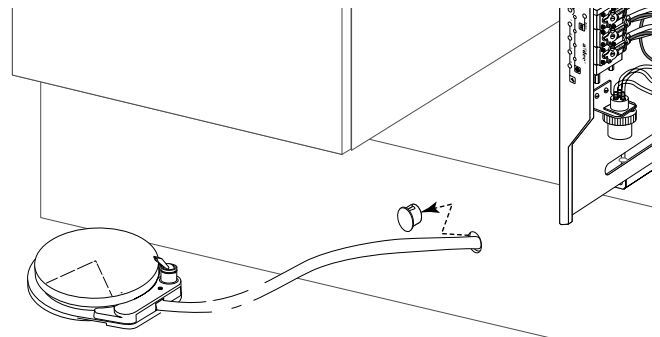

FIGURE 6

NOTE

If installing the 4631 Duo Delivery System, go to **CHECK UNIT CONNECTIONS** (right).

ROUTE THE UMBILICAL

1. Install the umbilical clip in the upper right corner of the cabinet, then route the umbilical through the clip and to the utilities.

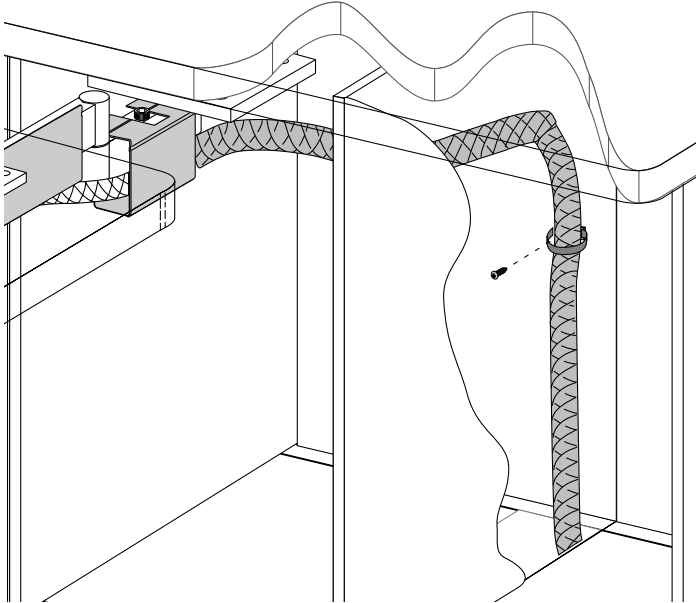

FIGURE 7

2. Slide the umbilical through the umbilical cover, then install the cover to the work surface arm using two button-head screws from the kit. Secure the umbilical by clipping the second umbilical cover over the work surface arm.

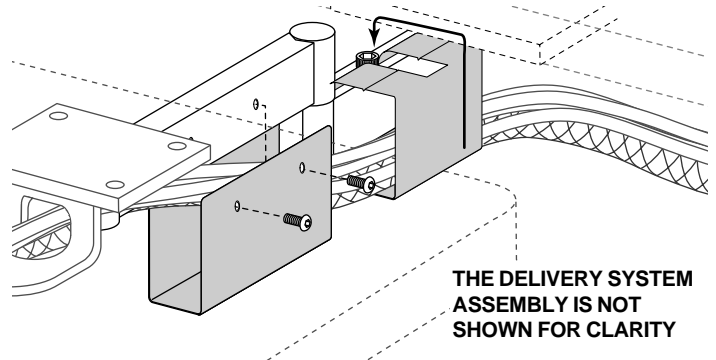

FIGURE 8

CHECK UNIT CONNECTIONS

1. Connect the foot control tubing, if present, to the umbilical tubing from the control head.
2. Connect the tubing as necessary (see Figure 9).

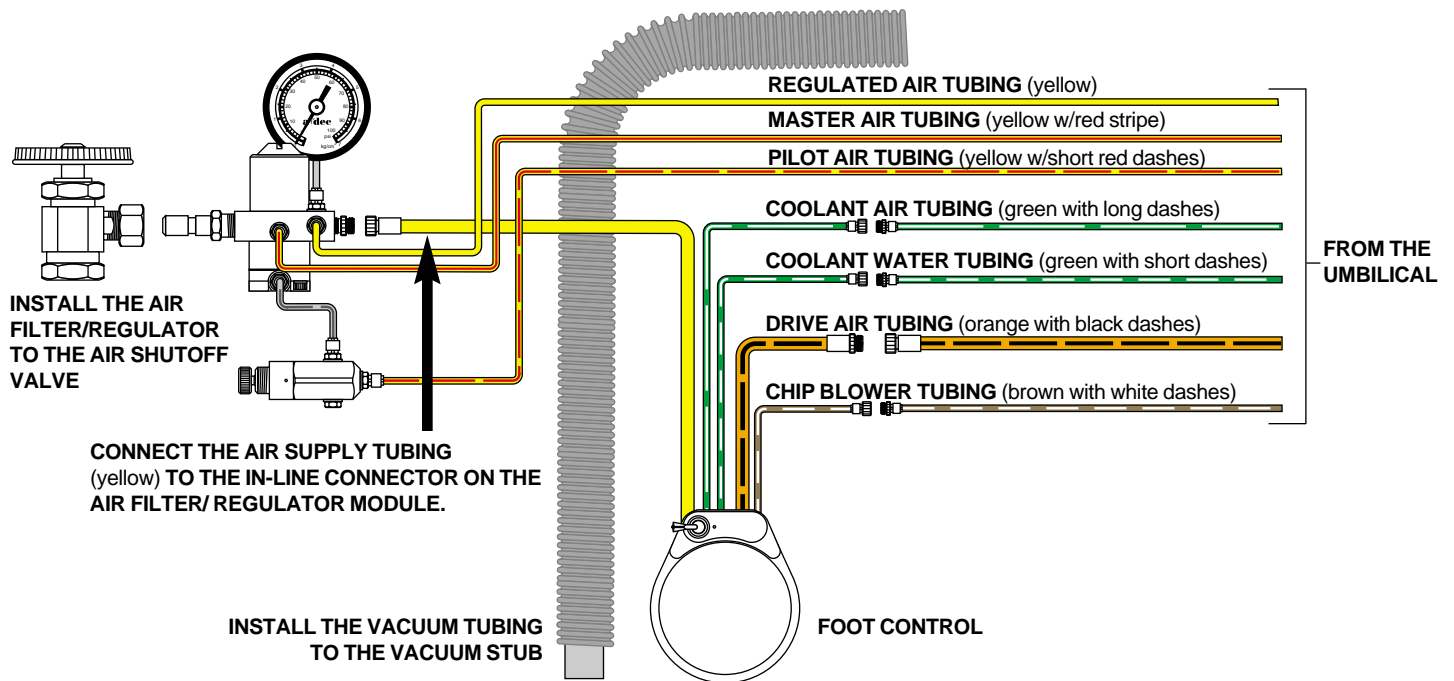

FIGURE 9

LEVEL THE WORK SURFACE

1. Cut the slotted plastic shims from the kit in half.
2. Loosen the work surface mounting screws.
3. Insert shims between the work surface and the mounting bracket until the work surface is level.

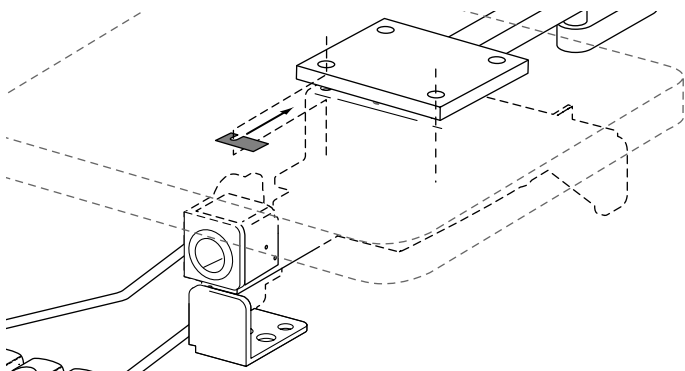

FIGURE 10

TEST THE HANDPIECES

1. Fill the self-contained water bottle with water specified by the dental team.

NOTE

The doctor may object to putting office water through the unit. Check with the doctor before putting water in the bottle.

2. Align the bottle with the self-contained water supply cap, making sure the 1/4" clear tubing extends straight down into the water bottle. Screw the water bottle onto the cap until it is snug.
3. Fully open the manual air shutoff valve.
4. Move the master on/off toggle (located on the control head) to the ON position.

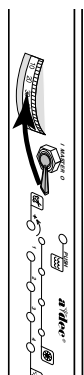

FIGURE 11

5. Check the system pressure gauges. Air pressure should be 70–80 psi (483–552 kPa) and water pressure should be 35–40 psi (241–276 kPa).
6. If an optional power supply is installed, plug it in.

TEST THE SYRINGE AND ASSISTANT'S INSTRUMENTATION

1. Check for air and water leaks while operating the syringe.
 - Air—Press the right button down.
 - Water—Press the left button down.
 - Spray—Press both buttons down.



FIGURE 12

2. Install the HVE vacuum connector from the kit into the vacuum canister.

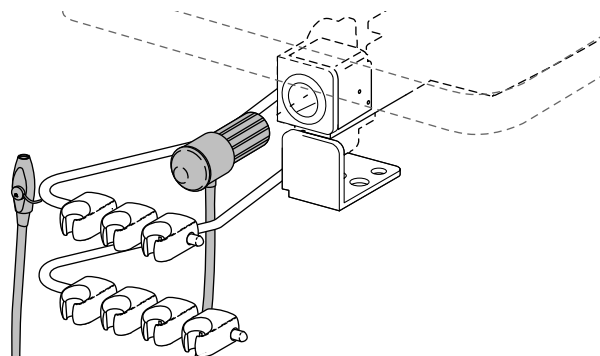

FIGURE 13

3. Test the vacuum instruments.

BEFORE LEAVING THE FACILITY

1. Reinstall all doors and the false bottom to the cabinet.
2. Distribute the **Owner's Guide(s)** and instruct the dental team in the operation and maintenance of the equipment.